

CLIENT :
KERALA LIFE MISSION

GENERAL NOTES :
1. Do not Scale drawings. Dimension govern.
2. All Dimensions are in centimetre unless noted otherwise.
3. All dimensions shall be verified on site before proceeding with the work.
4. All Levels are in Metres unless noted otherwise.

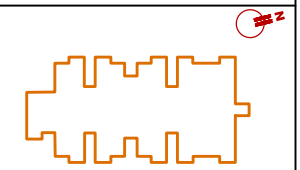

PRESENTATION DWG

AREA CALCULATION:

GROUND FLOOR	628.09 SQ.M
FIRST FLOOR	615.37 SQ.M
SECOND FLOOR	615.37 SQ.M
THIRD FLOOR	615.37 SQ.M
STAIR ROOM	14.28 SQ.M
TOTAL AREA	2488.48 SQ.M

DRAWING CATEGORY: RESIDENTIAL

- INFORMATION
- REVIEW
- APPROVAL
- CONSTRUCTION
- REVISE

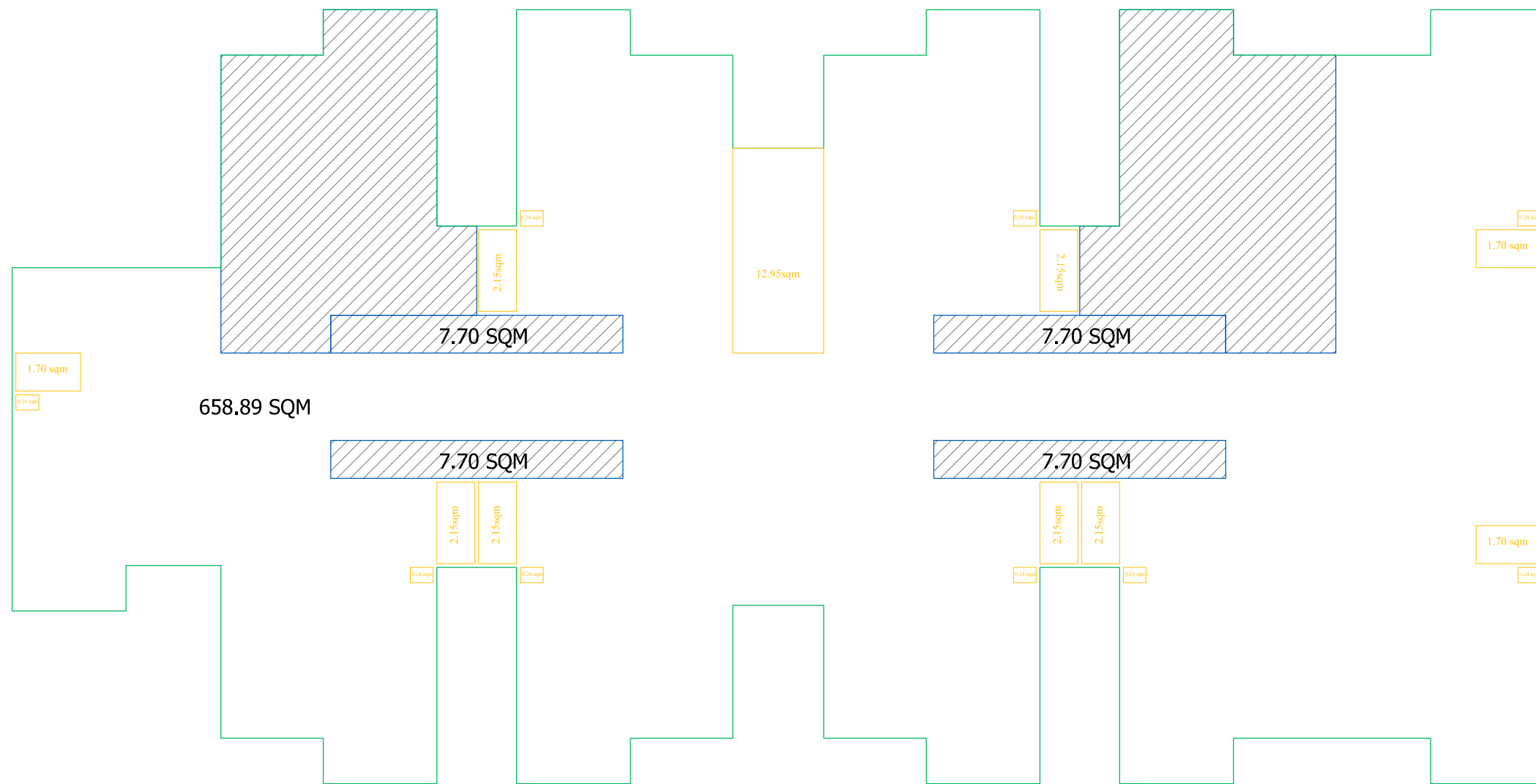

PLINTH AREA OF GROUND FLOOR = $658.89 - (7.70 \times 4) = 628.09 \text{ sqm}$
 DEDUCTIONS = $(0.24 \times 9) + [(1.70 \times 3) + (2.15 \times 6)] / 2 = 2.16 + (5.1 + 12.9) / 2 = 11.16 \text{ sqm}$
 FAR AREA OF FLOOR = $628.09 - 11.16 = 616.93 \text{ sqm}$
 RECREATION AREA IN GF FLOOR = $7.70 \times 4 + 48.01 \times 2 = 126.82 \text{ sqm}$

AREA CALCULATION : GROUND FLOOR

LIFE MISSION - IDUKKI 46 APARTMENTS COMPLEX

DISCLAIMER : THESE DRAWINGS ARE THE SOLE PROPERTY OF HABITAT TECHNOLOGY GROUP. NO CHANGES OR COPIES CAN BE MADE WITHOUT THE CONSENT OF HTG.
ALL MEASUREMENTS MUST BE RECHECKED ON THE SITE PRIOR TO EXECUTION.

Habitat
 TECHNOLOGY GROUP
 POOJAPPURA
 THIRUVANANTHAPURAM-12
 TEL: 0471-2344904, 2342723
 FAX: 0471- 2344977
 e-mail habitat@asianetindia.com
 web www.habitatgroup.org

SCALE -NTS	DRAWN BY -NIKITA
DATE : 04-02-19	
DRAWING NO:	HTG/2019/LM/IDK/09
REVISION	01