

CLIENT :
KERALA LIFE MISSION

GENERAL NOTES :
1. Do not Scale drawings. Dimension govern.
2. All Dimensions are in centimetre unless noted otherwise.
3. All dimensions shall be verified on site before proceeding with the work.
4. All Levels are in Metres unless noted otherwise.

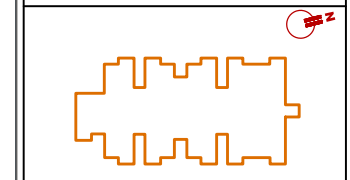

PRESENTATION DWG

AREA CALCULATION:

GROUND FLOOR	628.09 SQ.M
FIRST FLOOR	615.37 SQ.M
SECOND FLOOR	615.37 SQ.M
THIRD FLOOR	615.37 SQ.M
STAIR ROOM	14.28 SQ.M
TOTAL AREA	2488.48 SQ.M

DRAWING CATEGORY: RESIDENTIAL

- INFORMATION
- REVIEW
- APPROVAL
- CONSTRUCTION
- REVISE

Habitat
TECHNOLOGY GROUP
POOJAPPURA
THIRUVANANTHAPURAM-12
TEL: 0471-2344904, 2342723
FAX: 0471- 2344977
e-mail habitat@asianetindia.com
web www.habitatgroup.org

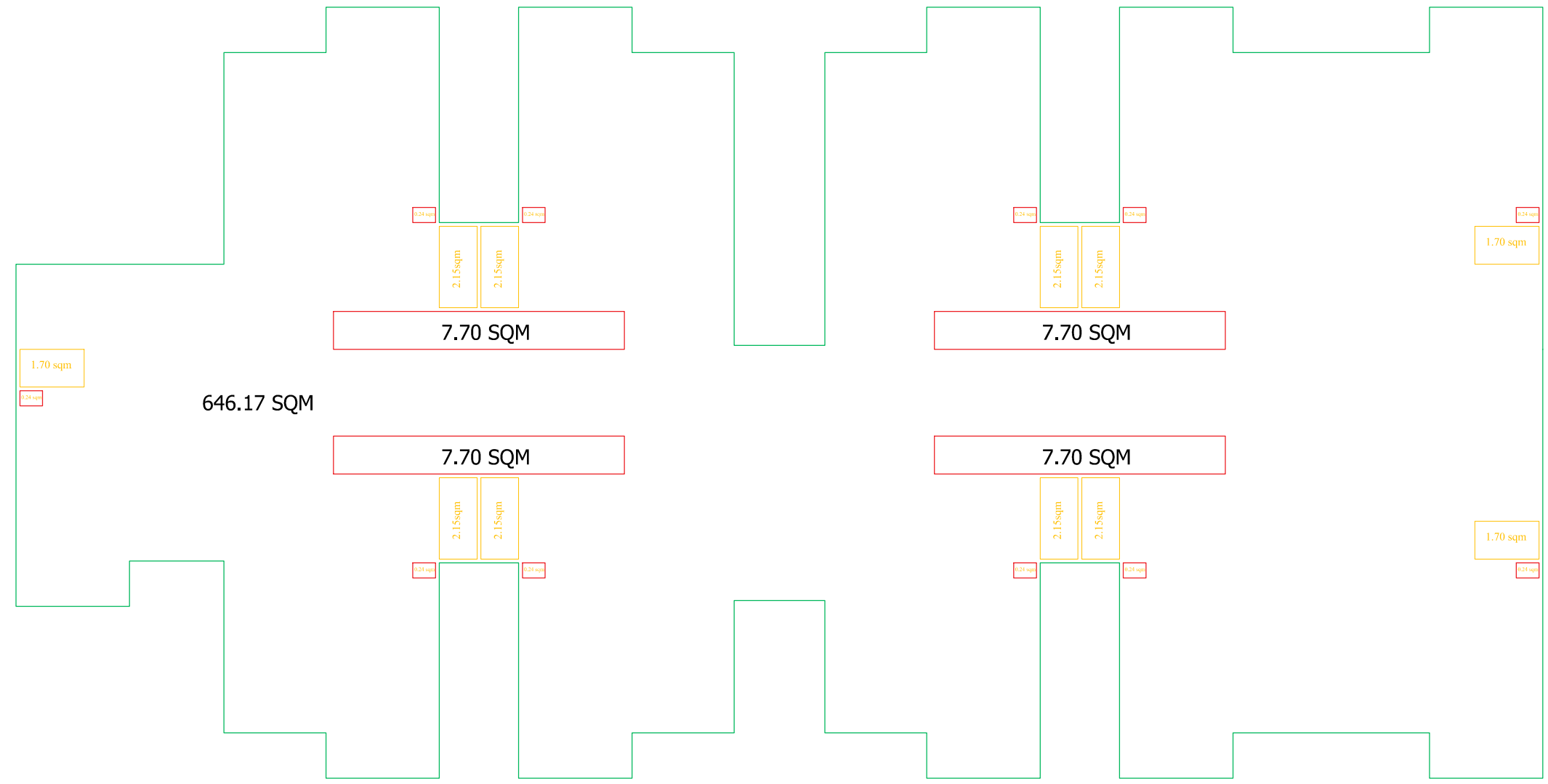

PLINTH AREA OF TYPICAL FLOOR (1ST-3RD) = $646.17 - (7.70 \times 4) = 615.37 \text{ sqm}$
 DEDUCTIONS = $(0.24 \times 11) + [(1.70 \times 3) + (2.15 \times 8)] / 2 = 2.64 + (5.1 + 17.2) / 2 = 13.79 \text{ sqm}$
 FAR AREA OF FLOOR = $615.37 - 13.79 = 601.58 \text{ sqm}$

AREA CALCULATION : TYPICAL FLOOR

LIFE MISSION - IDUKKI 46 APARTMENTS COMPLEX

DISCLAIMER : THESE DRAWINGS ARE THE SOLE PROPERTY OF HABITAT TECHNOLOGY GROUP. NO CHANGES OR COPIES CAN BE MADE WITHOUT THE CONSENT OF HTG.
ALL MEASUREMENTS MUST BE RECHECKED ON THE SITE PRIOR TO EXECUTION.

SCALE -NTS	DRAWN BY -NIKITTA
DATE : 04-02-19	
DRAWING NO:	HTG/2019/LM/IDK/10
REVISION	01