

CLIENT :  
KERALA LIFE MISSION

GENERAL NOTES :  
1. Do not Scale drawings. Dimension govern.  
2. All Dimensions are in centimetre unless noted otherwise.  
3. All dimensions shall be verified on site before proceeding with the work.  
4. All Levels are in Metres unless noted otherwise.

PRESENTATION DWG

AREA CALCULATION:

|              |              |
|--------------|--------------|
| GROUND FLOOR | 545.33 SQ.M  |
| FIRST FLOOR  | 556.21 SQ.M  |
| SECOND FLOOR | 556.21 SQ.M  |
| THIRD FLOOR  | 556.21 SQ.M  |
| STAIR ROOM   | 15.12 SQ.M   |
| TOTAL AREA   | 2229.08 SQ.M |

DRAWING CATEGORY: RESIDENTIAL

- INFORMATION
- REVIEW
- APPROVAL
- CONSTRUCTION
- REVISE

**Habitat**  
TECHNOLOGY GROUP  
POOJAPPURA  
THIRUVANANTHAPURAM-12  
TEL: 0471-2344904, 2342723  
FAX: 0471- 2344977  
e-mail habitat@asianetindia.com  
web www.habitatgroup.org

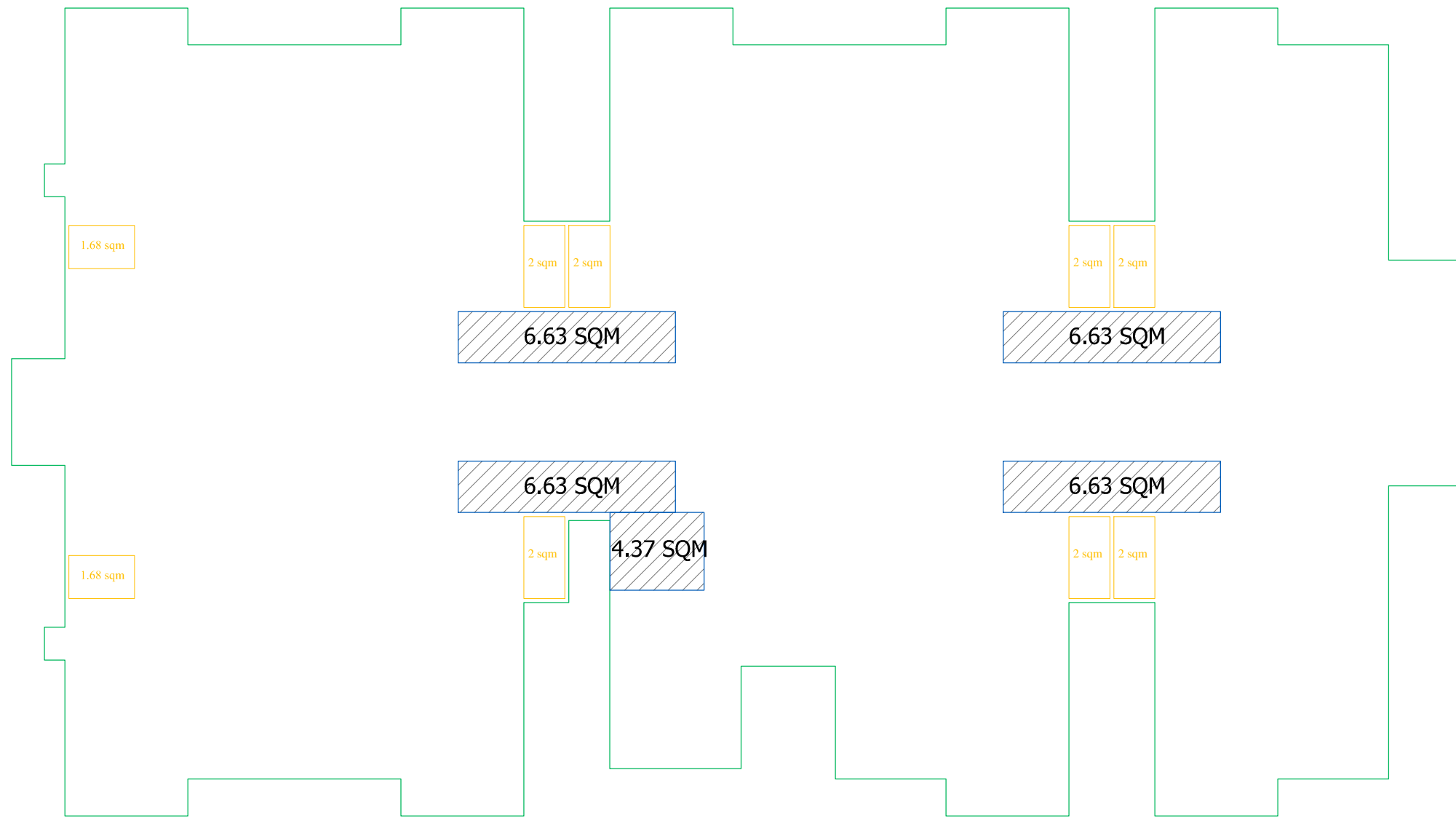

PLINTH AREA OF GROUND FLOOR =  $571.85 - (6.63 \times 4) = 545.33 \text{ sqm}$

DEDUCTIONS =  $(0.24 \times 2) + (7 \times 2) / 2 = 0.48 + 7 = 7.48 \text{ sqm}$

FAR AREA OF FLOOR =  $545.33 - 7.48 = 537.85 \text{ sqm}$

RECREATION AREA IN GF FLOOR =  $6.63 \times 4 + 4.37 = 30.89 \text{ sqm}$

AREA CALCULATION - GROUND FLOOR

LIFE MISSION - THRISSUR 234 APARTMENTS COMPLEX

DISCLAIMER : THESE DRAWINGS ARE THE SOLE PROPERTY OF HABITAT TECHNOLOGY GROUP. NO CHANGES OR COPIES CAN BE MADE WITHOUT THE CONSENT OF HTG. ALL MEASUREMENTS MUST BE RECHECKED ON THE SITE PRIOR TO EXECUTION.

|                |                    |
|----------------|--------------------|
| SCALE -1:50    | DRAWN BY -NIKITA   |
| DATE -05-02-19 |                    |
| DRAWING NO:    | HTG/2019/LM/THR/08 |
| REVISION       | 1                  |